

↗ **DOMETIC**

MOBILE COOLING

CFF

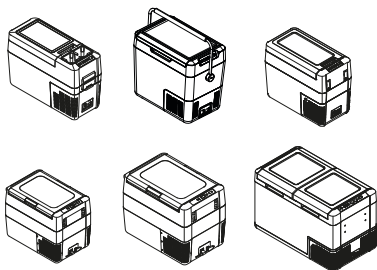

CFF12, CFF18, CFF20, CFF35, CFF45, CFF70DZ

EN

Mobile refrigerating appliance

Short operating manual

© 2023 Dometic Group. The visual appearance of the contents of this manual is protected by copyright and design law. The underlying technical design and the products contained herein may be protected by design, patent or be patent pending. The trademarks mentioned in this manual belong to Dometic Sweden AB. All rights are reserved.

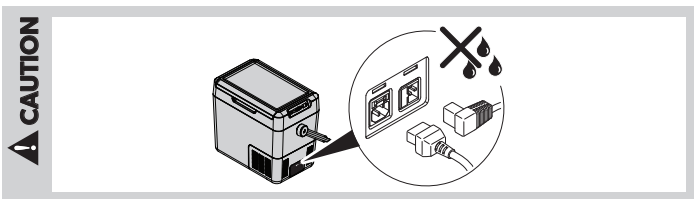
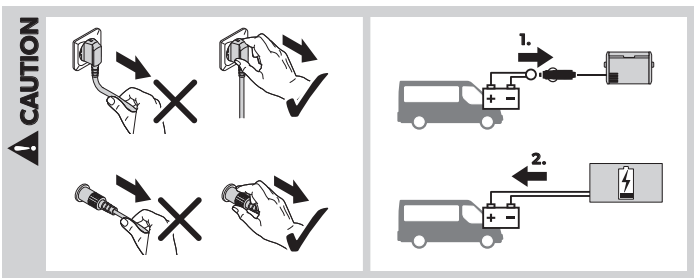
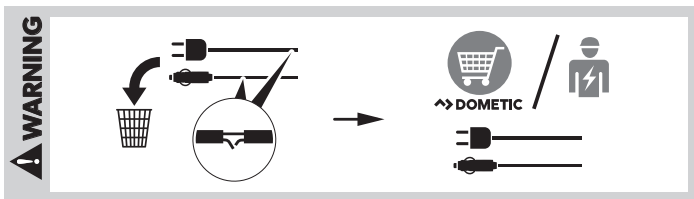

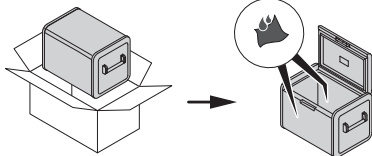
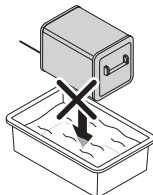
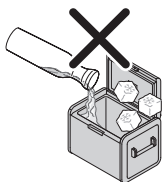
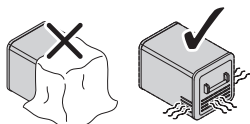
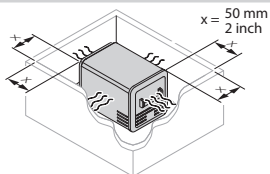
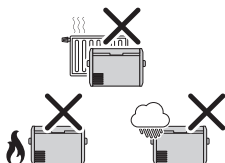
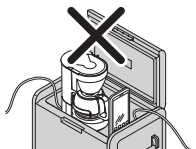
NOTICE

1



12/24V DC



100-240 V AC

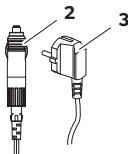
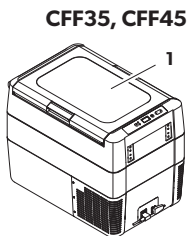
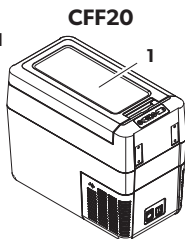
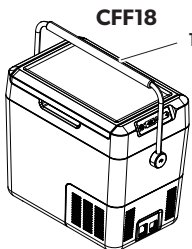
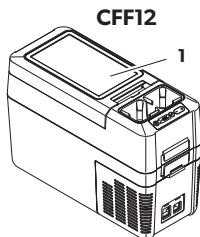

**CFF20, CFF35,
CFF45, CFF70DZ**

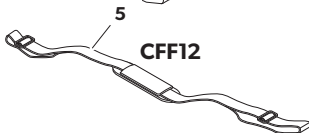
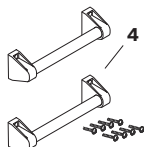
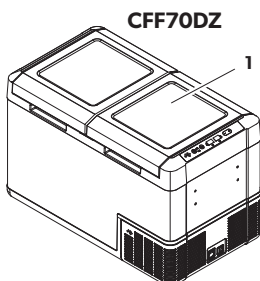

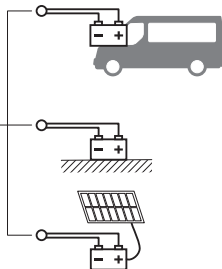
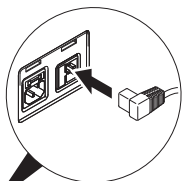
2

3

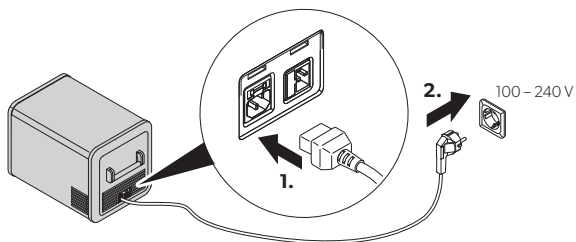

4

CFF12

**CFF18, CFF20, CFF35,
CFF45, CFF70DZ**

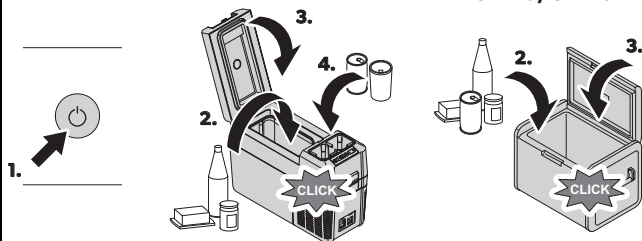

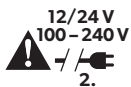
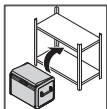
5

12/24 V

100-240 V

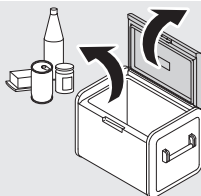
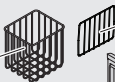
CFF35,
CFF45,
CFF70DZ

CFF18

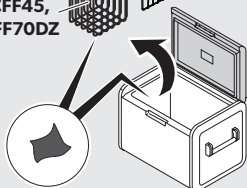
CFF35,
CFF45,
CFF70DZ

CFF18

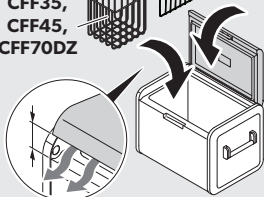

6**CFF12, CFF18, CFF20, CFF35, CFF45**

1.



2.

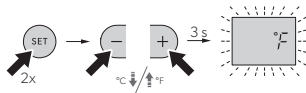

3.

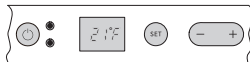
**CFF70DZ**

1.



2.

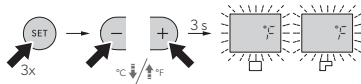

3.



7**CFF12, CFF18, CFF20, CFF35, CFF45**

1.



2.

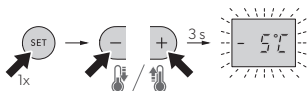

3.

**CFF70DZ**

1.



2.

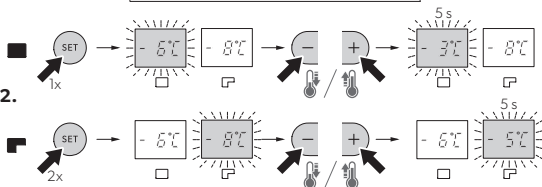

3.

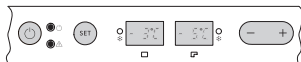

8

CFF12, CFF18, CFF20, CFF35, CFF45

- 1.
- 2.
- 3.

CFF70DZ

- 1.
- 2.
- 3.

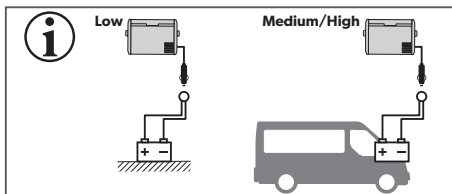

		Low	Medium	High
	OFF	10.1V	11.2V	11.8V
	ON	11.4V	12.2V	12.6V
	OFF	21.5V	24.1V	24.6V
	ON	23.0V	25.3V	26.2V

9

CFF12, CFF18, CFF20, CFF35, CFF45

1.



2.

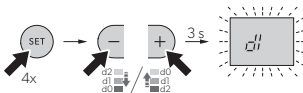

3.

**CFF70DZ**

1.



2.

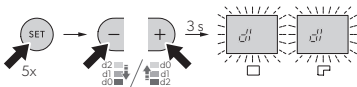

3.



10**CFF70DZ**

1.

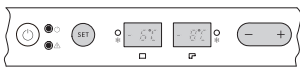

2.

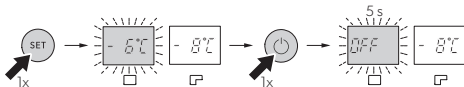

3.



1.

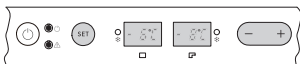

2.

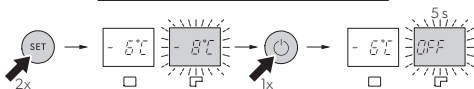

3.



11**CFF70DZ**

1.



2.

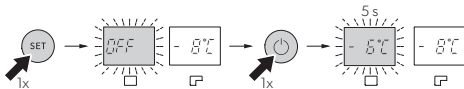

3.



1.



2.

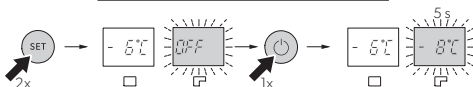

3.

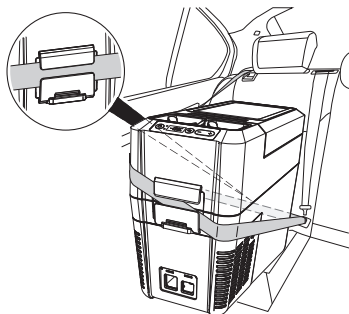
**12**

EN

Please read these instructions carefully and follow all instructions, guidelines, and warnings included in this product manual in order to ensure that you install, use, and maintain the product properly at all times. These instructions **MUST** stay with this product.

By using the product, you hereby confirm that you have read all instructions, guidelines, and warnings carefully and that you understand and agree to abide by the terms and conditions as set forth herein. You agree to use this product only for the intended purpose and application and in accordance with the instructions, guidelines, and warnings as set forth in this product manual as well as in accordance with all applicable laws and regulations. A failure to read and follow the instructions and warnings set forth herein may result in an injury to yourself and others, damage to your product or damage to other property in the vicinity. This product manual, including the instructions, guidelines, and warnings, and related documentation, may be subject to changes and updates. For up-to-date product information, please visit documents.dometic.com.



Find the full operating manual online on
[documents.dometic.com/
?object_id=71706](http://documents.dometic.com/?object_id=71706)

**WARNING!**

Also observe the safety instructions on page 3 to page 4.

1 Safety instructions

**DANGER! Failure to obey these warnings will result in death or serious injury.****Electrocution hazard**

- On boats: If the device is powered by the mains, ensure that the power supply has a residual current device (RCD), a residual current circuit breaker (RCCB), or a ground fault circuit interrupter (GFCI). Installation, especially in potentially damp areas, must be in accordance with all applicable installation regulations.
- Do not touch exposed cables with your bare hands. This applies especially when operating the device from the AC mains.
- Before starting the device, ensure that the power supply line and the plug are dry.

**WARNING! Failure to obey these warnings could result in death or serious injury.****Electrocution hazard**

- Do not operate the cooling device if it is visibly damaged.
- If the cooling device's power cable is damaged, it must be replaced with a suitable power cable or assembly available from the manufacturer or its service agent to prevent safety hazard.
- This cooling device may only be repaired by qualified personnel. Improper repairs can lead to considerable hazards.

EN

- Plug the device to sockets that ensure proper connection especially when the device needs to be earthed.

Fire hazard

- When positioning the device, ensure the supply cord is not trapped or damaged.
- Do not locate multiple portable socket-outlets or portable power supplies at the rear of the device.
- Keep the ventilation openings on the device housing or in installations free of obstructions.
- Do not use any mechanical objects or other means to speed up the defrosting process, unless they have been recommended by the manufacturer for this purpose.
- Do not open or damage the refrigerant circuit.
- Do not use electrical devices inside the cooling device unless they are recommended by the manufacturer for that purpose.

Health hazard

- This device is not intended for use by persons (including children) with reduced physical, sensory or mental capabilities, or lack of experience and knowledge, unless they have been given supervision or instruction concerning use of the device by a person responsible for their safety.
- Children aged from 3 to 8 years are allowed to load and unload cooling devices.
- Children must be supervised to ensure that they do not play with the device.
- Cleaning and user maintenance must not be carried out by unsupervised children.

Explosion hazard

- Do not store any explosive substances such as spray cans with a flammable propellant in the cooling device.



CAUTION! Failure to obey these cautions could result in minor or moderate injury.

Electrocution hazard

- Before starting the cooling device, ensure that the power supply line and the plug are dry.
- Disconnect the cooling device from the power supply
 - Before each cleaning and maintenance
 - After every use

Health hazard

To avoid contamination of food, observe the following instructions:

- Check if the cooling capacity of the device is suitable for storing the food to be cooled.
- Food may only be stored in its original packaging or in suitable containers.
- Opening the cooling device for long periods of time can cause significant increase of the temperature in the compartments of the device.
- Clean regularly surfaces that can come in contact with food and accessible drainage systems.

- If the device is left empty for long periods:
 - Switch off the device.
 - Defrost the device.
 - Clean and dry the device.
 - Leave the lid open to prevent mold developing within the device.



NOTICE! Damage hazard

- Check that the voltage specification on the data plate corresponds to that of the energy supply.
- Only connect the cooling device as follows:
 - With the DC connection cable to a DC power supply in the vehicle
 - Or with the AC connection cable to an AC power supply
- Never pull the plug out of the socket by the cable.
- If the cooling device is connected to a DC outlet, disconnect the cooling device and other power consuming devices from the battery before connecting a quick charging device.
- If the cooling device is connected to a DC outlet, disconnect the cooling device or switch it off when turning off the engine. Otherwise the battery may be discharged.
- The cooling device is not suitable for transporting caustic materials or materials containing solvents.
- Do not place the cooling device near naked flames or other heat sources (heaters, direct sunlight, gas ovens etc.).
- **Risk of overheating!**
Ensure at all times that there is a minimum of 50 mm ventilation on all sides of the cooling device. Keep the ventilation area free of any objects that could obstruct the air flow to the cooling components.
Do not use or store the cooling device in closed compartments or areas with none or minimal air flow.
- Do not fill the inner container with ice or fluids.
- Never immerse the cooling device in water.
- Protect the cooling device and cables against heat and moisture.
- The device shall not to be exposed to rain.

2 Intended use

The cooling device is suitable for cooling food. The cooling device is suitable for use in vehicles or on boats.

The cooling device is designed to be operated from a DC on-board power supply of a vehicle or boat, a DC auxiliary battery or from an AC power supply.

The cooling device is suitable for camping use.

The cooling device is intended to be used in household and similar applications such as

- staff kitchen areas in shops, offices and other working environments
- farm houses
- clients in hotels, motels and other residential type environments
- bed and breakfast type environments

- catering and similar non-retail applications

This product is only suitable for the intended purpose and application in accordance with these instructions.

This manual provides information that is necessary for proper installation and/or operation of the product. Poor installation and/or improper operating or maintenance will result in unsatisfactory performance and a possible failure.

The manufacturer accepts no liability for any injury or damage to the product resulting from:

- Incorrect assembly or connection, including excess voltage
- Incorrect maintenance or use of spare parts other than original spare parts provided by the manufacturer
- Alterations to the product without express permission from the manufacturer
- Use for purposes other than those described in this manual

Dometic reserves the right to change product appearance and product specifications.

3 Operation

3.1 Saving energy

- Choose a well ventilated location which is protected from direct sunlight.
- Allow warm food to cool down first before placing it in the cooling device to keep cool.
- Do not open the cooling device more often than necessary.
- Do not leave the cooling device open for longer than necessary.
- If the cooler has a basket: For optimal energy consumption, position the basket according to its position on delivery.
- On a regular basis, make sure the lid seal still fits properly.

3.2 Operating

To avoid food waste, note the following:

- Keep temperature fluctuation as low as possible. Only open the cooling device as often and for as long as necessary. Store the foodstuff in such a way that the air can still circulate well.
- Adjust the temperature to the quantity and type of the foodstuff.
- Foodstuff can easily absorb or release odor or taste. Always store foodstuff covered or in closed containers/bottles.

Scope of delivery: fig. **1**

Proceed as shown:

- Connecting to a battery: fig. **2**
- Connecting to an AC power supply: fig. **3**
- Switching on the cooler: fig. **4**
- Switching off and storing the cooler: fig. **5**
- Selecting the temperature units: fig. **6**
- Setting the temperature: fig. **7**
- Using the battery monitor: fig. **8**
- Setting the display's brightness: fig. **9**
- Switching off the compartments: fig. **10**

- Switching on the compartments: fig. **11**
- Fixing with safety belt (CFF12): fig. **12**

4 Warranty

If the product does not work as it should, please contact your retailer or the manufacturer's branch in your country (see dometic.com/dealer). The warranty applicable to your product is 3 year(s).

For repair and warranty processing, please include the following documents when you send in the device:

- A copy of the receipt with purchasing date
- A reason for the claim or description of the fault

Australia only

Our goods come with guarantees that cannot be excluded under the Australian Consumer Law. You are entitled to a replacement or refund for a major failure and for compensation for any other reasonably foreseeable loss or damage. You are also entitled to have the goods repaired or replaced if the goods fail to be of acceptable quality and the failure does not amount to a major failure.

New Zealand only

This warranty policy is subject to the conditions and guarantees which are mandatory as implied by the Consumer Guarantees Act 1993(NZ).

Local support

Please find local support at the following link address: dometic.com/dealer

5 Disposal

Recycling packaging material



- Place the packaging material in the appropriate recycling waste bins wherever possible.

Recycling products with non-replaceable batteries, rechargeable batteries or light sources



- If the product contains any non-replaceable batteries, rechargeable batteries or light sources, you don't have to remove them before disposal.
- If you wish to finally dispose of the product, ask your local recycling center or specialist dealer for details about how to do this in accordance with the applicable disposal regulations.





dometic.com

**YOUR LOCAL
DEALER**

dometic.com/dealer

**YOUR LOCAL
SUPPORT**

dometic.com/contact

**YOUR LOCAL
SALES OFFICE**

dometic.com/sales-offices
